



NH TOOLS

Ferramentas Intercambiáveis

Catálogo de ferramentas

CHANFRADOR - HASTE

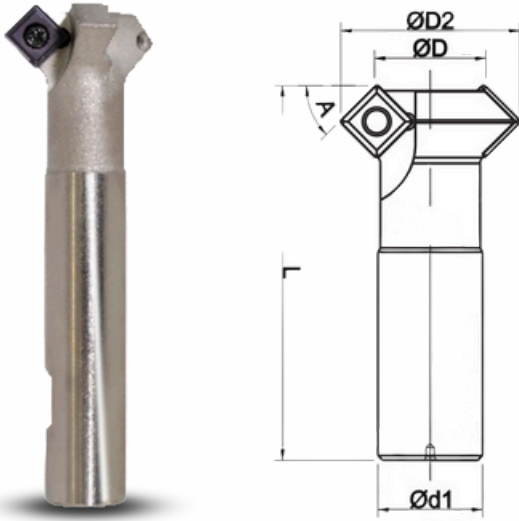

FRESA TOPO 90°



CÓDIGO	ØD	Z	ØD2	Ød1	L	A	INSERTO
D7A21,9.1.H20.L120.45°	7	1	21,9	20	120	45°	SP...11
D19A33,9.2.H20.L120.45°	19	2	33,9	20	120	45°	
D25A39,9.3.H20.L120.45°	25	3	39,9	20	120	45°	
D5,4A22,9.1.H20.L175.45°	5,4	1	22,9	20	175	45°	SP...12
D25A43.2.H25.L150.45°	25	2	43	25	150	45°	
D32A49.3.H32.L300.45°	32	3	49	32	300	45°	
D0A12.1.H16.L120.45°	0	1	12	16	120	45°	TC...09 TC...16
D12A23,5.3.H16.L100.45°	12	3	23,5	16	100	45°	
D16.A35,8.2.H25.L100.45°	16	2	35,8	25	100	45°	

CÓDIGO	ØD	Z	Ød1	l1	L	INSERTO
D16.1.H16.L150	16	1	16	50	150	ED...14
D20.2.H20.L150	20	2	20	50	150	
D25.2.H25.L150	25	2	25	50	150	
D25.3.H25.L170	25	3	25	50	170	
D32.3.H25.L150	32	3	25	50	150	
D32.4.H32.L180	32	4	32	50	180	
D40.4.H32.L180	40	4	32	50	180	ED...18
D25.2.H25.L150	25	2	25	50	150	
D32.3.H32.L150	32	3	32	50	150	
D40.4.H32.L200	40	4	32	50	200	

CABEÇOTE 90°

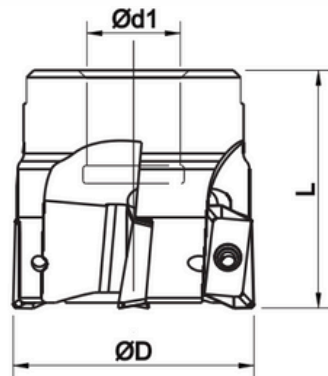

FRESA ESFÉRICA - MODULAR

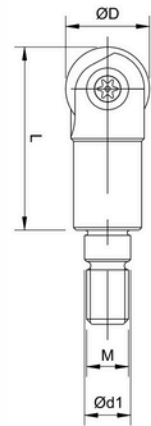

CÓDIGO	ØD	Z	Ød1	L	INSERTO
D40.4.FC16.L40	40	4	16	40	ED...14
D50.5.FC22.L40	50	5	22	40	
D63.6.FC22.L40	63	6	22	40	
D80.7.FC27.L50	80	7	27	50	
D50.4.FC22.L40	50	4	22	40	ED...18
D63.5.FC22.L40	63	5	22	40	
D80.6.FC27.L50	80	6	27	50	
D100.7.FC32.L50	100	7	32	50	
D125.8.FC40.L63	125	8	40	63	
D160.10.FC40.L63	160	10	40	63	

CÓDIGO	ØD	Z	Ød1	M	L	INSERTO
D10.1.ER.M16	10	1	6,5	M6	25	BALLNOSE
D12.1.ER.M8	12	1	8,5	M8	30	
D16.1.ER.M8	16	1	8,5	M8	35	
D20.1.ER.M10	20	1	10,5	M10	35	
D25.1.ER.M12	25	1	12,5	M12	40	
D32.1.ER.M16	32	1	17	M16	43	

Temos diversos diâmetros e comprimentos mediante consulta

FRESA ESFÉRICA - HASTE

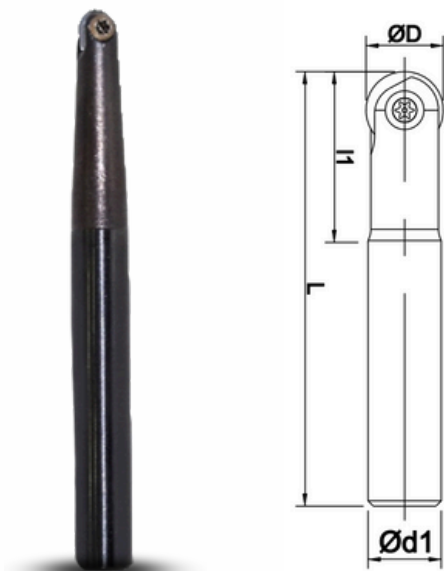

CÓDIGO	ØD	Z	Ød1	l1	L	INSERTO
D8.1.H10.L110	8	1	10	25	110	BALLNOSE
D10.1.H10.L150	10	1	10	35	150	
D12.1.H11.L150	12	1	11	46	150	
D16.1.H15.L160	16	1	15	53	160	
D20.1.H19.L175	20	1	19	61	175	
D25.1.H24.L190	25	1	24	70	190	
D32.1.H32.L210	32	1	32	80	210	

WOODRUFF - HASTE

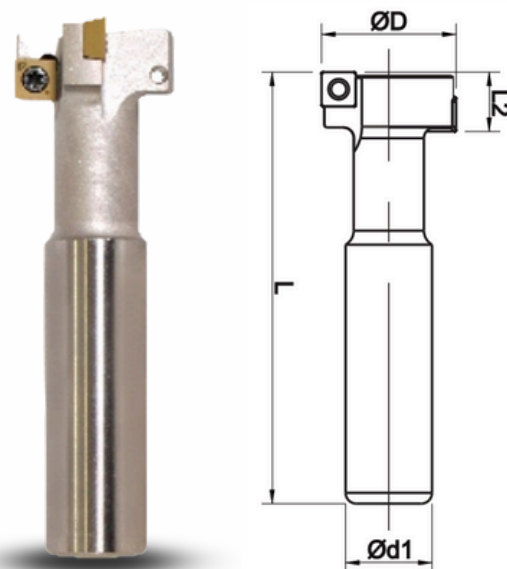

CÓDIGO	ØD	Z	Ød1	l2	L	INSERTO
D21X9.4.H20.L100	21	4	20	9	100	SP...06
D23X9.4.H16.L85	23	4	16	9	85	
D25X11.4.H16.L80	25	4	16	11	80	
D30X11.4.H25.L110	30	4	25	11	110	
D30X8,5.4.H20.L75	30	4	20	8,5	75	
D32X13,9.4.H16.L90	32	4	16	13,9	90	SP...09
D37X16.4.H32.L200	37	4	32	16	200	
D40X17,9.4.H25.L105	40	4	25	17,9	105	

PROLONGADOR

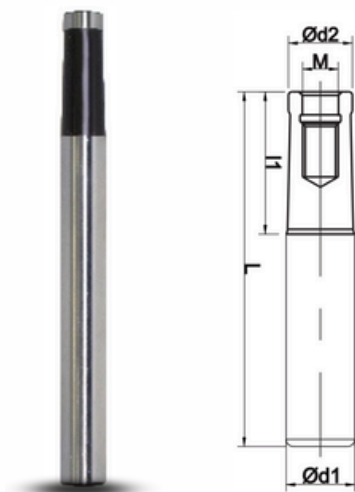

CÓDIGO	M	Ød2	Ød1	l1	L
M6.H10.L100	M6	9,5	10	30	100
M6.H11.L150	M6	9,7	11	40	150
M8.H15.L100	M8	12,7	15	30	100
M8.H15.L150	M8	12,7	15	40	150
M8.H15.L200	M8	12,7	15	50	200
M10.H19.L100	M10	17,7	19	30	100
M10.H19.L150	M10	17,7	19	40	150
M10.H19.L200	M10	17,7	19	50	200
M10.H19.250	M10	17,7	19	50	250
M10.H20.L150	M10	17,7	20	40	150

PROLONGADOR

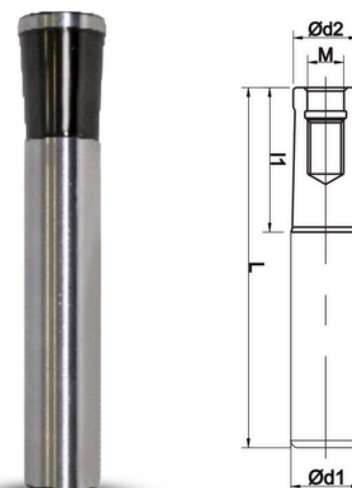

CÓDIGO	M	Ød2	Ød1	l1	L
M12.H24.L100	M12	20,7	24	35	100
M12.H24.L150	M12	20,7	24	40	150
M12.H24.L200	M12	20,7	24	50	200
M12.H24.L250	M12	20,7	24	50	250
M12.H25.L150	M12	20,7	25	40	150
M16.H25.L150	M16	28,7	25	40	150
M16.H25.L200	M16	28,7	25	50	200
M16.H25.L250	M16	28,7	25	50	250
M16.H32.L150	M16	28,7	32	40	150
M16.H32.L200	M16	28,7	32	50	200

Temos diversos diâmetros e comprimentos mediante consulta

FRESA DE TOPO 90°

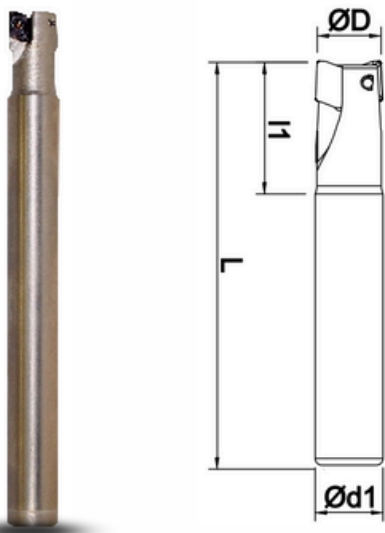

CÓDIGO	ØD	Z	Ød1	l1	L	INSERTO
D8.1.H7.8.L120	8	1	1	21	120	AX...06 XD...07 AD...07 AP...06 AO...07 BD...07 XO...06
D8.1.H8.L120	8	1	1	21	120	
D10.2.H9.8.L120	10	2	2	21	120	
D10.2.H10.L120	10	2	2	19	120	
D12.2.H11.L120	12	2	2	19	120	
D12.2.H11,8.L120	12	2	2	19	120	
D12.2.H12.L120	12	2	2	21	120	
D14.3.H13.L120	14	3	3	23	120	
D14.3.H14.L120	14	3	3	21	120	
D16.4.H15.L150	16	4	4	26	150	

FRESA MULTI FUNCIONAL- MODULAR

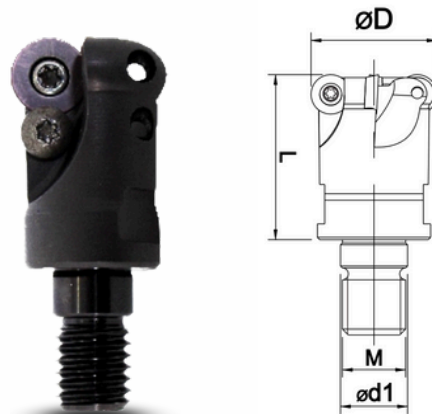

CÓDIGO	ØD	Z	Ød1	M	L	INSERTO
D10.2.ER.M6	10	2	6,5	M6	20	RD...05
D12.3.ER.M8	12	3	8,5	M8	23	RD...07
D16.2.ER.M8	16	2	8,5	M8	23	
D20.4.ER.M10	20	4	10,5	M10	30	
D20.2.ER.M10	20	2	10,5	M10	30	RD...10
D25.3.ER.M12	25	3	12,5	M12	35	
D32.4.ER.M16	32	4	17	M16	43	
D25.2.ER.M12	25	2	12,5	M12	35	
D32.3.ER.M16	32	3	17	M16	43	RD...12
D40.4.ER.M16	40	4	17	M16	43	

FRESA DE TOPO 90°

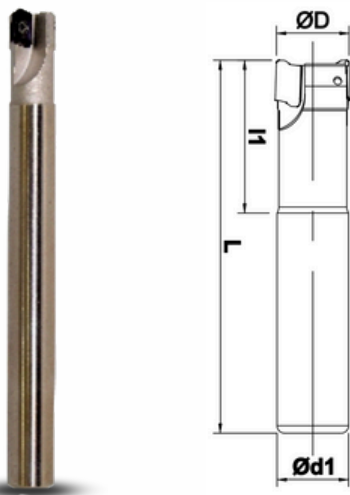

CÓDIGO	ØD	Z	Ød1	l1	L	INSERTO
D10.1.H10.L120	10	1	10	26	120	AP...09 - BD...11 AP...10 - XD...11 XO...12 - AS...11 AP...11 - XO...10 AD...11 - AP...12 AX...12 - AD...10 ED...10 - XD...09
D12.1.H12.L120	12	1	12	26	120	
D16.2.H15.L150	16	2	15	25	150	
D16.2.H16.L150	16	2	16	25	150	
D20.2.H19.L150	20	2	19	26	150	
D20.2.H20.L150	20	2	20	31	150	
D25.3.H24.L150	25	3	24	30	150	
D25.3.H25.L150	25	3	25	31	150	
D32.4.H25.L150	32	4	25	30	150	
D32.4.H32.L150	32	4	32	41	150	

CABEÇOTE MULTI FUNCIONAL

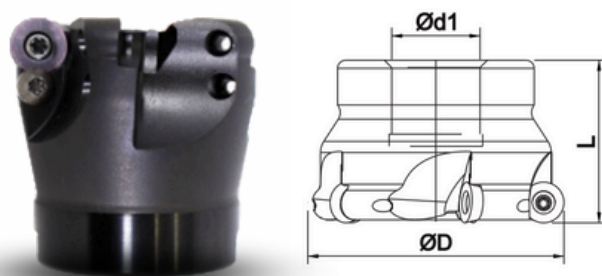

CÓDIGO	ØD	Z	Ød1	L	INSERTO
D40.4.FC16.L40	40	4	16	40	RD...10 RD...12
D50.5.FC22.L40	50	5	22	40	
D50.5.FC22.L50	50	5	22	50	
D52.5.FC22.L40	52	5	22	40	
D52.5.FC22.L50	52	5	22	50	
D63.5.FC22.L40	63	5	22	40	
D63.6.FC22.L50	63	6	22	50	
D80.6.FC27.L50	80	6	27	50	
D100.7.FC32.L50	100	7	32	50	
D125.8.FC40.L63	125	8	40	63	

Temos diversos diâmetros e comprimentos mediante consulta

FRESA MULTI FUNCIONAL

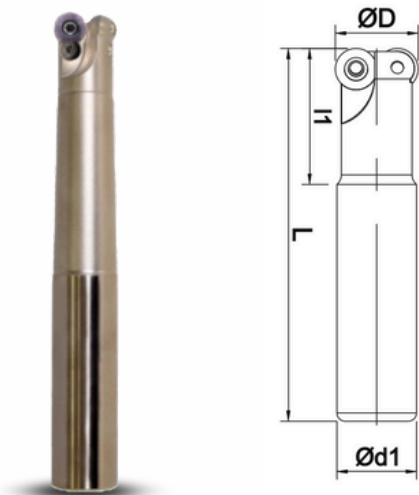

CÓDIGO	ØD	Z	Ød1	l1	L	INSERTO
D10.2.H9.8.L120	10	2	9,8	25	120	RD...05
D16.2.H15.L150	16	2	15	40	150	RD...07
D20.4.H19.L150	20	4	19	30	150	RD...10
D20.2.H19.L150	20	2	19	33	150	
D25.3.H24.L150	25	3	24	36	150	RD...12
D32.4.H25.L150	32	4	25	45	150	
D25.2.H24.L150	25	2	24	51	150	
D32.3.H25.L150	32	3	25	41	150	
D40.4.H32.L150	40	4	32	40	150	

FRESA XD DE 95° - MODULAR

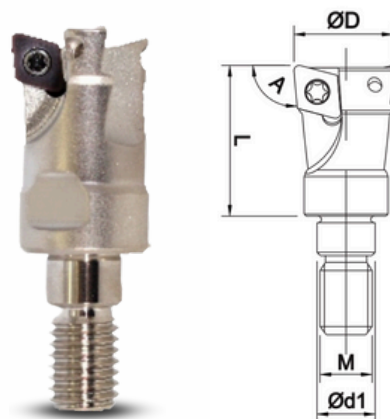

CÓDIGO	ØD	Z	Ød1	M	L	A	INSERTO
D10.2.ER.M6.95°	10	2	6,5	M6	20	95°	XD...04
D12.2.ER.M6.95°	12	2	6,5	M6	20	95°	
D16.2.ER.M8.95°	16	2	8,5	M8	23	95°	XD...06
D20.3.ER.M10.95°	20	3	10,5	M10	30	95°	
D25.3.ER.M12.95°	25	3	12,5	M12	35	95°	
D32.4.ER.M16.95°	32	4	17	M16	43	95°	
D42.5.ER.M16.95°	42	5	17	M16	43	95°	XD...10
D25.2.ER.M12.95°	25	2	12,5	M12	35	95°	
D32.3.ER.M16.95°	32	3	17	M16	43	95°	
D35.3.ER.M16.95°	35	3	17	M16	43	95°	

FRESA CN 90° E 93° - HASTE

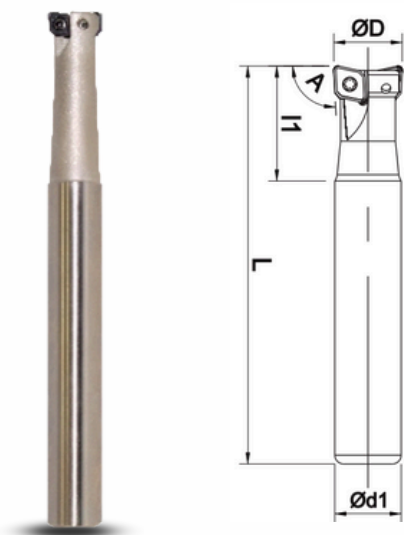

CÓDIGO	ØD	Z	Ød1	l1	L	A	INSERTO
D16.2.H15.L100.90°	16	2	15	26	100	90°	CN...07
D16.2.H15.L100.93°	16	2	15	26	100	93°	
D16.2.H15.L150.90°	16	2	15	26	150	90°	
D16.2.H15.L150.93°	16	2	15	26	150	93°	
D20.3.H19.L150.90°	20	3	19	29	150	90°	
D20.3.H19.L150.93°	20	3	19	29	150	93°	
D25.4.H24.L150.90°	25	4	24	29	150	90°	
D25.4.H24.L150.93°	25	4	24	31	150	93°	
D32.5.H25.L150.90°	32	5	25	35	150	90°	
D32.5.H25.L150.93°	32	5	25	35	150	93°	

FRESA CN 90° E 93° - MODULAR

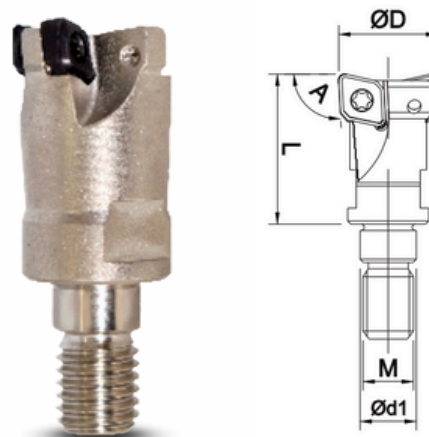

CÓDIGO	ØD	Z	Ød1	M	L	A	INSERTO
D16.2.ER.M8.90°	16	2	8,5	M8	23	90°	CN...07
D16.2.ER.M8.93°	16	2	8,5	M8	23	93°	
D20.3.ER.M10.90°	20	3	10,5	M10	30	90°	
D20.3.ER.M10.93°	20	3	10,5	M10	30	93°	
D25.4.ER.M12.90°	25	4	12,5	M12	35	90°	
D25.4.ER.M12.93°	25	4	12,5	M12	35	93°	
D32.5.ER.M16.90°	32	5	17	M16	43	90°	
D32.5.ER.M16.93°	32	5	17	M16	43	93°	
D35.5.ER.M16.93°	35	5	17	M16	43	93°	
D42.4.ER.M16.93°	42	4	17	M16	43	93°	

Temos diversos diâmetros e comprimentos mediante consulta

FRESA LN...03 DE ALTO AVANÇO

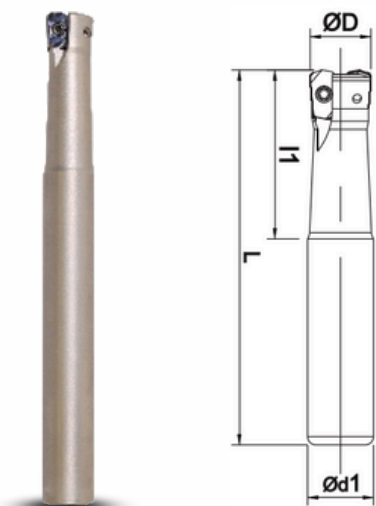

FRESA WX DE ALTO AVANÇO

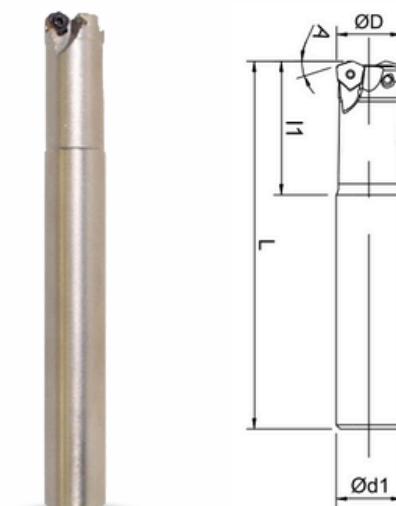

CÓDIGO	ØD	Z	Ød1	l1	L	INSERTO
D16.2.H15.L150	16	2	15	30	150	LN...03
D16.2.H16.L150	16	2	16	50	150	
D20.3.H19.L150	20	3	19	40	150	
D20.3.H20.L150	20	3	20	80	150	
D20.4.H19.L150	20	4	19	40	150	
D25.4.H24.L150	25	4	24	40	150	
D25.4.H25.L150	25	4	25	70	150	
D25.5.H24.L150	25	5	24	40	150	
D32.5.H25.L150	32	5	25	36	150	
D32.5.H32.L150	32	5	32	70	150	

CÓDIGO	ØD	Z	Ød1	l1	L	A	INSERTO
D16.2.H15.L150.17°	16	2	15	33	150	17°	WX...04
D16.2.H16.L150.17°	16	2	16	50	150	17°	
D20.3.H19.L150.17°	20	3	19	43	150	17°	
D20.3.H20.L150.17°	20	3	20	50	150	17°	
D25.4.H24.L150.17°	25	4	24	40	150	17°	
D25.4.H25.L150.17°	25	4	25	50	150	17°	
D25.3.H24.L150.17°	25	3	24	40	150	17°	WX...05
D32.3.H32.L150.17°	32	3	32	73	150	17°	
D32.4.H25.L150.17°	32	4	25	40	150	17°	
D32.4.H25.L200.17°	32	4	25	40	200	17°	

FRESA ZD DE ALTO AVANÇO

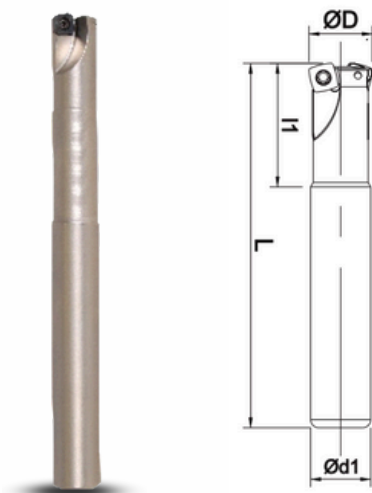

FRESA JO E JD DE ALTO AVANÇO

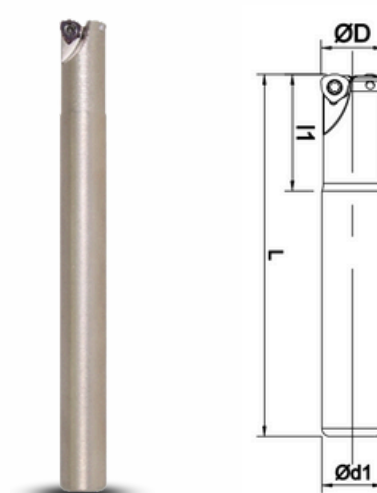

CÓDIGO	ØD	Z	Ød1	l1	L	INSERTO
D16.2.H15.L145	16	2	15	65	145	ZD...07
D16.2.H16.L150	16	2	16	65	150	
D20.3.H19.L165	20	3	19	32	165	
D20.3.H20.L165	20	3	20	80	165	
D25.3.H24.L190	25	3	24	100	190	
D25.3.H25.L190	25	3	25	40	190	
D20.2.H19.L200	20	2	19	30	200	ZD...09
D25.3.H24.L200	25	3	24	31	200	
D32.3.H25.L200	32	3	25	80	200	
D40.4.H32.L240	40	4	32	80	240	

CÓDIGO	ØD	Z	Ød1	l1	L	INSERTO
D16.2.H15.L150	16	2	15	31	150	JO...06
D18.2.H17.L150	18	2	17	31	150	
D20.3.H19.L150	20	3	19	31	150	
D20.3.H20.L150	20	3	20	50	150	
D25.4.H24.L150	25	4	24	31	150	
D25.4.H25.L150	25	4	25	60	150	
D25.4.H24.L200	25	4	24	31	200	JO...08
D20.2.H20.L130	20	2	20	50	130	
D25.3.H24.L150	25	3	24	40	150	
D32.3.H32.L200	32	3	32	120	200	

Temos diversos diâmetros e comprimentos mediante consulta

FRESA LN...12 DE 90° - 4 ARESTAS

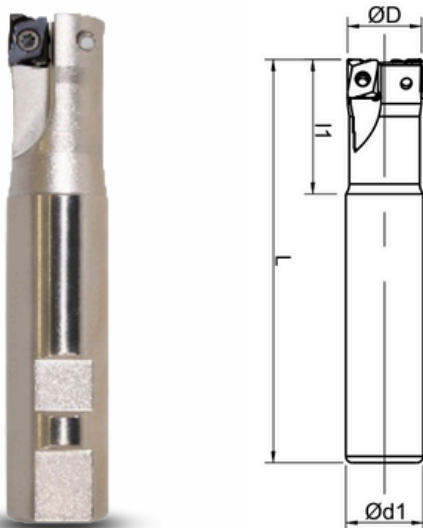

CÓDIGO	ØD	Z	Ød1	l1	L	INSERTO
D25.2.H24.L200	25	2	24	42	200	LN...12
D25.2.H25.L120	25	2	25	44	120	
D32.2.H25.L200	32	2	25	42	200	
D32.3.H25.L195	32	3	25	42	195	
D32.3.H25.L280	32	3	25	42	280	
D32.3.H32.L100.WELDON	32	3	32	44	100	
D32.3.H32.L120.WELDON	32	3	32	44	120	
D40.4.H32.L120.WELDON	40	4	32	50	120	
D40.4.H32.L200	40	4	32	50	200	

CABEÇOTE LN...12 DE 90° 4 ARESTAS

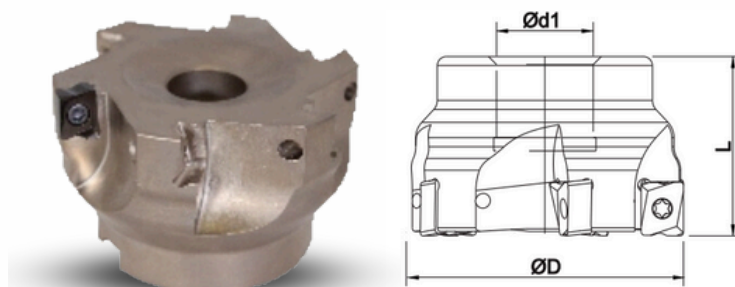

CÓDIGO	ØD	Z	Ød1	L	INSERTO
D40.4.FC16.L40	40	4	16	40	LN...12
D50.4.FC22.L40	50	4	22	40	
D63.5.FC22.L40	63	5	22	40	
D80.5.FC27.L50	80	5	27	50	
D80.6.FC27.L50	80	6	27	50	
D100.6.FC32.L50	100	6	32	50	
D100.7.FC32.L50	100	7	32	50	
D125.7.FC40.L63	125	7	40	63	
D160.10.FC40.L63	160	10	40	63	

CABEÇOTE LN...15 DE 90° 4 ARESTAS

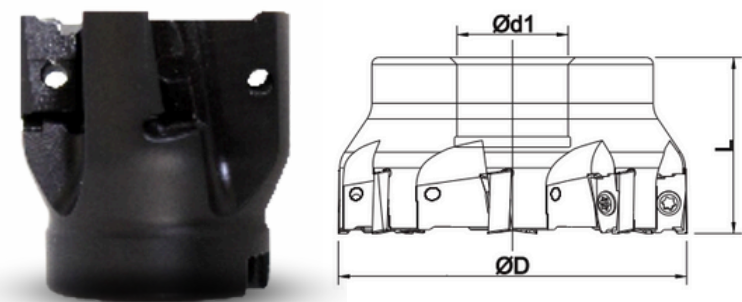

CÓDIGO	ØD	Z	Ød1	L	INSERTO
D40.4.FC16.L40	40	4	16	40	LN...15
D50.5.FC22.L40	50	5	22	40	
D63.6.FC22.L40	63	6	22	40	
D80.7.FC27.L50	80	7	27	50	
D100.8.FC32.L50	100	8	32	50	

FRESA LN...10 DE 90° - 4 ARESTAS

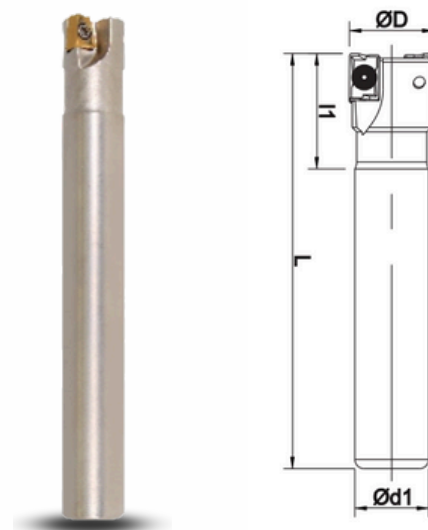

CÓDIGO	ØD	Z	Ød1	l1	L	INSERTO
D16.1.H16.L150	16	1	16	36	150	LN...10
D18.2.H18.L150	18	2	18	36	150	
D20.2.H19.L150	20	2	19	30	150	
D20.2.H20.L100	20	2	20	30	100	
D25.3.H24.L150	25	3	24	35	150	
D25.3.H25.L150	25	3	25	35	150	
D32.4.H32.L150	32	4	32	40	150	
D32.4.H32.L200	32	4	32	60	200	
D40.5.H32.L130	40	5	32	42	130	
D40.5.H32.L150	40	5	32	42	150	

Temos diversos diâmetros e comprimentos mediante consulta

CABEÇOTE HN...09 DE 45°

CABEÇOTE HN...06 E 07 DE 45°

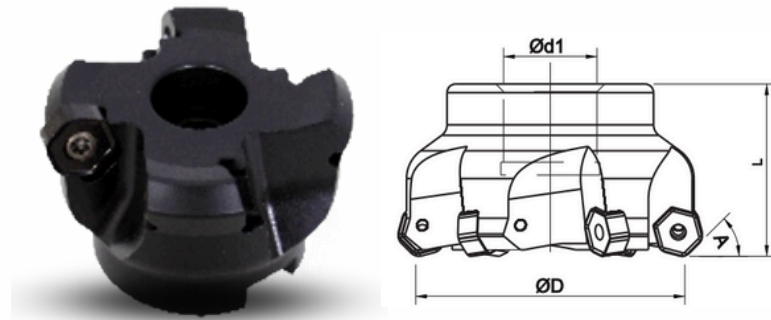
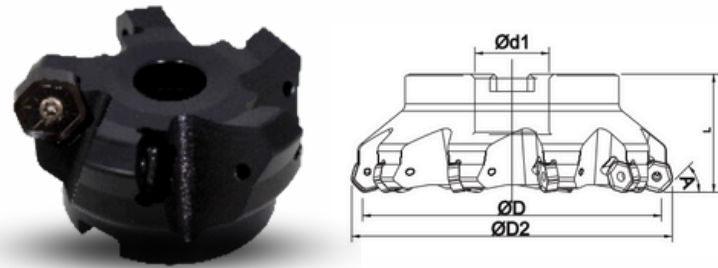

CÓDIGO	ØD	Z	Ød1	L	A	INSERTO
D50.4.FC22.L40.45°	50	4	22	40	45°	HN...09
D63.5.FC22.L40.45°	63	5	22	40	45°	
D80.6.FC27.L50.45°	80	6	27	50	45°	
D80.7.FC27.L50.45°	80	7	27	50	45°	
D100.7.FC32.L50.45°	100	7	32	50	45°	
D100.8.FC32.L50.45°	100	8	32	50	45°	
D125.8.FC40.L63.45°	125	8	40	63	45°	
D125.10.FC40.L63.45°	125	10	40	63	45°	
D160.10.FC40.L63.45°	160	10	40	63	45°	
D200.12.FC60.L63.45°	200	12	60	63	45°	

CÓDIGO	ØD	Z	Ød1	L	A	INSERTO
D40.4.FC16.L40.45°	40	4	16	40	45°	HN...06 HN...07
D50.4.FC22.L40.45°	50	4	22	40	45°	
D50.5.FC22.L40.45°	50	5	22	40	45°	
D63.5.FC22.L40.45°	63	5	22	40	45°	
D63.6.FC22.L40.45°	63	6	22	40	45°	
D80.6.FC27.L50.45°	80	6	27	50	45°	
D80.7.FC27.L50.45°	80	7	27	50	45°	
D100.7.FC32.L50.45°	100	7	32	50	45°	
D125.8.FC40.L63.45°	125	8	40	63	45°	
D160.10.FC40.L63.45°	160	10	40	63	45°	

CABEÇOTE DE APROVEITAMENTO

FRESA DE APROVEITAMENTO

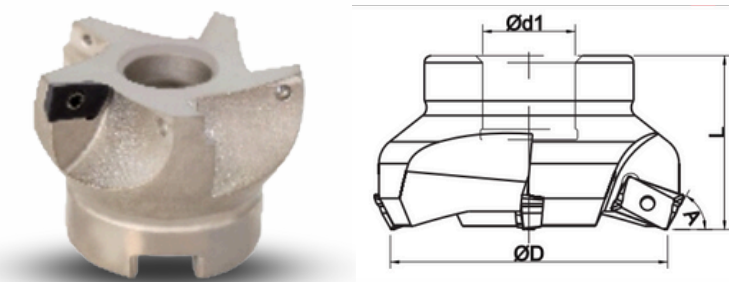

CÓDIGO	ØD	Z	Ød1	L	A	INSERTO
D40.4.FC16.L40.60°	40	4	16	40	60°	APROVEITAMENTO DE PASTILHAS 90° DIVERSAS
D50.4.FC22.L40.60°	50	4	22	40	60°	
D50.5.FC22.L40.60°	50	5	22	40	60°	
D63.5.FC22.L40.60°	63	5	22	40	60°	
D80.4.FC27.L50.60°	80	4	27	50	60°	
D80.5.FC27.L50.60°	80	5	27	50	60°	
D80.6.FC27.L50.60°	80	6	27	50	60°	
D100.5.FC32.L50.60°	100	5	32	50	60°	
D125.6.FC40.L63.60°	125	6	40	63	60°	
D125.7.FC40.L63.60°	125	7	40	63	60°	

CÓDIGO	ØD	Z	Ød1	L	A	INSERTO
D25.2.H20.L120.60°	25	2	20	120	60°	APROVEITAMENTO DE PASTILHAS 90° DIVERSAS
D32.3.H25.L120.60°	32	3	25	120	60°	
D40.3.H20.L100.60°	40	3	20	100	60°	
D40.4.H20.L100.60°	40	4	20	100	60°	
D50.5.H25.L100.60°	50	5	25	100	60°	
D55.5.H25.L85.60°	55	5	25	85	60°	

Temos diversos diâmetros e comprimentos mediante consulta

CABEÇOTE OF...05 E 06

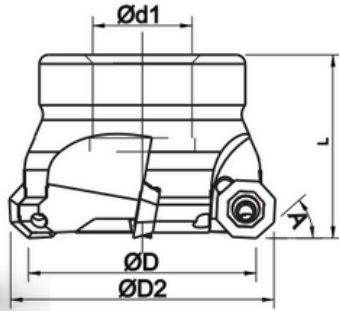

CÓDIGO	ØD	Z	Ød1	L	A	INSERTO
D50.4.FC22.L40.42°	50	4	22	40	42°	OF...05
D63.5.FC22.L40.42°	63	5	22	40	42°	
D80.6.FC27.L50.42°	80	6	27	50	42°	
D100.7.FC32.L50.42°	100	7	32	50	42°	
D100.8.FC32.L50.42°	100	8	32	50	42°	
D63.5.FC22.L40.43°	63	5	22	40	43°	OF...06
D125.12.FC40.L63.43°	125	12	40	63	43°	
D200.8.FC60.L63.43°	200	8	60	63	43°	

FRESA VC...11 E 22 90°

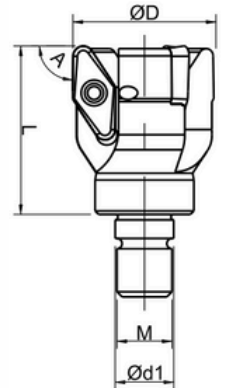

CÓDIGO	ØD	Z	Ød1	M	L	A	INSERTO
D12.1.ER.M8.90°	12	1	8,5	M8	23	23	VC...11
D15.2.ER.M8.90°	15	2	8,5	M8	23	23	
D16.2.ER.M8.90°	16	2	8,5	M8	23	23	
D20.2.ER.M10.90°	20	2	10,5	M10	30	30	
D25.3.ER.M12.90°	25	3	12,5	M12	35	35	
D32.4.ER.M16.90°	32	4	17	M16	43	43	VC...22
D32.2.ER.M16.90°	32	2	17	M16	43	43	
D35.3.ER.M16.90°	35	3	17	M16	43	43	
D40.3.ER.M16.90°	40	3	17	M16	43	43	
D42.3.ER.M16.90°	42	3	17	M16	43	43	

FRESA DE TOPO 90°

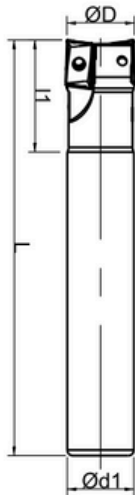

CÓDIGO	ØD	Z	Ød1	l1	L	INSERTO
D22.2.H20.L150	22	2	20	40	150	AP...16
D25.2.H24.L150	25	2	24	41	150	
D25.2.H25.L150	25	2	25	41	150	
D25.2.H24.L200	25	2	24	41	200	
D30.3.H25.L150	30	3	25	41	150	
D32.3.H25.L150	32	3	25	41	150	
D32.3.H32.L150	32	3	32	41	150	
D32.3.H32.L200	32	3	32	41	200	
D40.4.H25.L150	40	4	25	41	150	
D40.4.H32.L150	40	4	32	41	150	

CABEÇOTE 90°

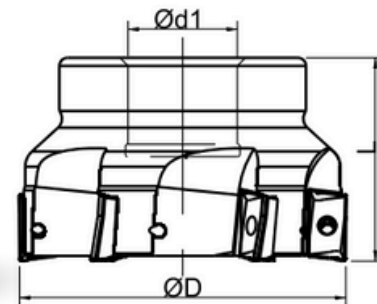

CÓDIGO	ØD	Z	Ød1	L	INSERTO
D40.4.FC16.L40	40	4	16	40	AP...16
D50.4.FC22.L40	50	4	22	40	
D50.5.FC22.L40	50	5	22	40	
D63.5.FC22.L40	63	5	22	40	
D80.6.FC27.L50	80	6	27	50	
D100.7.FC32.L50	100	7	32	50	
D125.8.FC40.L63	125	8	40	63	
D160.9.FC40.L63	160	9	40	63	

Temos diversos diâmetros e comprimentos mediante consulta

FRESA ABACAXI

FRESA TPK...16

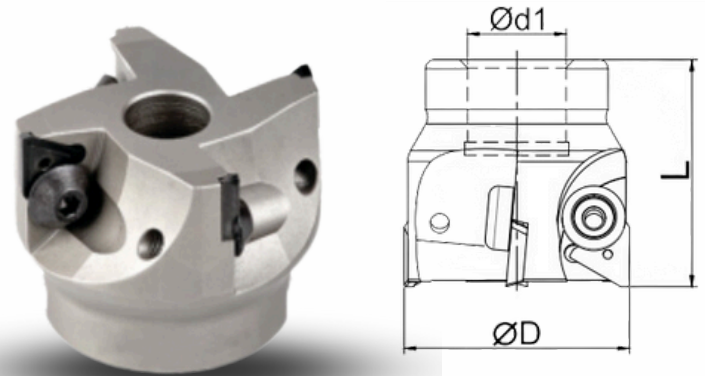
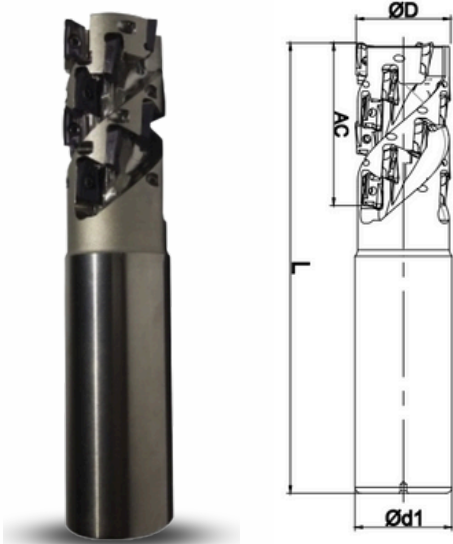

CÓDIGO	ØD	Z	Ød1	AC	L	INSERTO
D20.2X4.H20.L150	20	2X4	20	53	150	DIVERSOS 90°
D25.2X4.H25.L130	25	2X4	25	31	130	
D25.2X7.H25.L130.H1-55,0	25	2X7	25	55	130	
D32.2X4.H32.L130	32	2X4	32	58	130	
D32.3X6.H32.L150	32	3X6	32	54	150	
D32.4X4.H32.L120	32	4X4	32	52	120	
D32.4X5.H32.L120	32	4X5	32	47	120	
D40.2X4.H32.L150	40	2X4	32	58	150	
D40.3X4.H32.L130	40	3X4	32	58	130	

CÓDIGO	ØD	Z	Ød1	L	INSERTO
D50.4.FC22.L50	50	4	22	50	TPK...16
D63.4.FC22.L50	63	4	22	50	
D80.5.FC27.L50	80	5	27	50	
D100.6.FC32.L50	100	6	32	50	
D125.6.FC40.L63	125	6	40	63	
D125.7.FC40.L63	125	7	40	63	
D160.8.FC40.L63	160	8	40	63	
D200.8.FC60.L63	200	8	60	63	

TABELA DE INSERTO

INSERTOS PARA QUAIS JÁ FABRICAMOS FERRAMENTAS

345R-1305	CNHT070310	OEMX12T3	RDMW1204	SOMT0904	WNMX0603	ZNMU0504
345R-13T5	CNHX050210	OFEX05T3	RDMW12T3	SOMT09T3	WNMX09T3	ZOMT0602
390R-0702	CNKT0703	OFKT05T3	RDMW1606	SOMT1004	WNXT0806	ZPMT1003
3PHT1004	CPMT0602	OFMT0504	RDMX0501	SOMT11T3	WOEJ0804	ZPMT1303
3PHT1505	CPMT0603	OFPT06L5	RFMT1404	SOMT1204	WOEJ0905	ZPMT1604



Temos diversos diâmetros e comprimentos mediante consulta

TABELA DE INSERTO

3PKT0603	CPMT09T3	OFPT07L6	RNGJ1204	SOMT1205	WOEJ1207
3PKT0603	CVKT0502	ONGX04T3	RNHX1204	SOMT12T3	WOMW04T2
3PKT1004	EDMT0702	ONGX0605	RNMU1004	SOMT1405	WPMT06X4
3PKT1505	EDNW10T3	ONHU0604	RNMU1205	SPGT050204	WPMT0806
490R-08T3	EDPT0703	ONHU0604	RNPJ10T3	SPGX0502	WPMW0302
490R-1404	EDPT10T3	ONHU08T5	ROHX10	SPGX0602	WPMW05X3
490R-1404	EDPT1404	ONHU08T5	ROHX1203	SPGX0903	WPMW06X4
4NKT0402	EDPT1805	ONHX0806	ROHX1604	SPHX0602	WPMW06X4
4NKT0603	EDPT1805	ONKT0505	ROHX2005	SPHX0703	WPZ08
4NKT0904	ENHT1004	ONMT05	RPHT10T3	SPHX0903	WPZ10
6NGU0604	ENMU1004	ONMU0505	RPHT1204	SPHX1204	WPZ12
6NGU0905	ENMX0604	ONMU0507	RPHT1605	SPKW08T3	WPZ16

ADKT1035	ENMX1206	ONMU0705	RPHT2006	SPMG0502	WPZ20
ADKT1505	EPEW0903	ONMU0806	RPHX10T3	SPMG0602	WXCU0403
ADMT0702	EPNW0603	ONMU0905	RPHX1204	SPMG07T3	WXCU05T3
ADMT0803	HBR12	ONMU1008	RPKT1204	SPMG0904	WXCU0806
ADMT1003	HBR16	ONMX0606	RPMT08T2	SPMG1104	WXHU0403
ADMT10T3	HNGX0604	PNMU0905	RPMT1040	SPMG1405	WXHX04T3
ADMT1204	HNMX0504	PNMU1205	RPMT10T3	SPMT0602	WXMU0303
ADMT1606	HNPJ0604	PNMU1206	RPMT1204	SPMT0603	XBMT08
ADMX0702	HNPJ0704	QDMT1205	RPMW1003	SPMT0903	XDCT1104
ADMX11T3	HNPJ0905	QOMT0830	RPMW10T3	SPMT09T3	XDGT1550
ADMX1606	HNPJ1307	QOMT1035	RPMW1204	SPMT1004	XDGX15M5
ADPT1035	HPPT06T3	QOMT1342	RPNX1605	SPMT1204	XDHT1904



Temos diversos diâmetros e comprimentos mediante consulta

TABELA DE INSERTO

ADKT1035	ENMX1206	ONMU0705	RPHT2006	SPMG0502	WPZ20
ADKT1505	EPEW0903	ONMU0806	RPHX10T3	SPMG0602	WXCU0403
ADMT0702	EPNW0603	ONMU0905	RPHX1204	SPMG07T3	WXCU05T3
ADMT0803	HBR12	ONMU1008	RPKT1204	SPMG0904	WXCU0806
ADMT1003	HBR16	ONMX0606	RPMT08T2	SPMG1104	WXHU0403
ADMT10T3	HNGX0604	PNMU0905	RPMT1040	SPMG1405	WXHX04T3
ADMT1204	HNMX0504	PNMU1205	RPMT10T3	SPMT0602	WXMU0303
ADMT1606	HNPJ0604	PNMU1206	RPMT1204	SPMT0603	XBMT08
ADMX0702	HNPJ0704	QDMT1205	RPMW1003	SPMT0903	XDCT1104
ADMX11T3	HNPJ0905	QOMT0830	RPMW10T3	SPMT09T3	XDGT1550
ADMX1606	HNPJ1307	QOMT1035	RPMW1204	SPMT1004	XDGX15M5
ADPT1035	HPPT06T3	QOMT1342	RPNX1605	SPMT1204	XDHT1904

ADPT1504	JDMT0702	QOMT1342	RPNX2006	SPMW0603	XDHW0401
ANGX1105	JDMT09T3	QOMT1651	RXCRO802	SPMW09T3	XDHW0466
ANGX1506	JDMT1003	QPMT1004	RXCW0702	SPMX0903	XDHW0602
ANHX1004	JDMT1505	QPMT10T3	RXXMX1003	SPMX12T3	XDHW0602
ANHX1607	JDMW1204	QPMT1204	RXXMX12T3	SPNW1004	XDHW0702
ANKT0702	JOMT0803	R210-090412	RYMX0803	SPPT10T3	XDHW10T3
ANKX0904	JOMW06T2	R216F-2050	RYMX1004	SPPX09T3	XDKT0703
ANKX1205	KDMB06	R245-12T3M	RYMX1205	SPPX1204	XDKT11T3
ANKX1207	KDMB08	R245-18T6	RYMX2007	SPPX15T5	XDKT1505
ANKX1607	KDMB10	R290-12T3	SCGX060204	SWMT1304	XDLT0904
ANKX1706	KDMB12	R390-11T3	SCMT09T3	SWMT13T3	XDLT10T3
ANMX1106	KDMB16	R39011T308	SCMT120408	SXHX0602	XDLT1205



Temos diversos diâmetros e comprimentos mediante consulta

TABELA DE INSERTO

AOMT0702-HJ	KDMB20	R390-11T331	SDHT0903	SXHX0703	XDLX09T3
AOMT0702-MJ	KDMB25	R390-1704	SDHT1204	SXHX0903	XDMT0903
AOMT11T3	KDMB32	R390-1704	SDHT1205	TCKT0703	XDMT1104
AOMT1236	KDMT10	R390-1806	SDMT0502	TCMT0902	XDMT11T3
AOMT1705	KDMT12	RB10N	SDMT0603	TCMT1102	XDMW0806
AOMT1848	KDMT16	RB12N	SDMT06T2	TCMT16T3	XDMX08T3
AONT10T3	KDMT20	RB16N	SDMT070308	TDKT1505	XDPT0904
APFT1604	KDMT25	RB20N	SDMT080308	TNGX1004	XDPT1104
APGT1604	KFB10	RB25N	SDMT0903	TNGX1606	XDPT1104
APKT0602	KFB12	RBS06	SDMT09T2	TNKX1005	XDPT1205
APKT0702	KFB20	RBS08	SDMT09T3	TNKX1606	XDPT1704
APKT0903	LNGU1104	RCGT10T3	SDMT1204	TNMG1604	XECT1605

APKT09T3	LNGU15T6	RCGT2006	SDMT1205	TNMU0703	XEKT19M5
APKT1003	LNGU1607	RCKT1204	SDMW09T3	TNMU1207	XMB12
APKT1135	LNGX1205	RCKT1304	SDMW1204	TOMT0402	XMB16
APKT11T3	LNGX1307	RCKT1604	SDMX1506	TOMT0603	XMB20
APKT1204	LNGX1507	RCKT2006	SDNT09T3	TOMT1004	XMB25
APKT1304	LNHT0804	RCMT0803	SDNW1205	TOMT1506	XNEX0403
APKT15T3	LNKX1607	RCMT10T3	SDPT1204	TPKN1603	XNEX0806
APKT1604	LNMT0804	RCMT1204	SDXT09M4	TPKN2204	XNGX0806
APKT1705	LNMT10	RCMT1606	SEET09T3	TPKN1603	XNKT0604
APKX1604	LNMT1306	RCMT1606	SEET09T3	TPKT0502	XNKT0805
APLX1003	LNMU0202	RCMT1607	SEET1203	TPKT1003	XNKU06T3
APMT0602	LNMU0303	RCMT2006	SEET1204	TPKX1004	XNMU0403



Temos diversos diâmetros e comprimentos mediante consulta

TABELA DE INSERTO

APMT0903	LNMU06T3	RCMW0803	SEET12T3	TPKX1505	XNMU0605
APMT1003	LNMU06X5	RCMX2006	SEKT1204	TPMT1603	XNMU0606
APMT1135	LNMU0906	RDCW10T3	SEKT12T3	TPMT16T3	XNMU0806
APMT11T3	LNMU1207	RDET0802	SEMT09T3	UDMT0803	XNMU0906
APMT1504	LNMX0405	RDET10T3	SEMT1203	UDMT080308	XNPU1004
APMT1604	LNMX0603	RDET1204	SEMT1304	VBMT1604	XNPU15T6
APMT2506	LNMX0804	RDHW0501	SEMT13T3	VCGT110308	XOGU1205
APPT1604	LNMX0906	RDHW0803	SEMX1204	VCGT1604	XOLX1204
APXT10T3	LNMX1006	RDHX0501	SEMX1505	VCGT2205	XOLX1906
APXT12T3	LNMX1510	RDHX0702	SENX09T3	WDKT080316	XOMT0602
ASGT11T3	LNXT0904	RDHX07T1	SEPT1404	WDKT10T3	XOMX0602
ASMT11T3	LOEX0804	RDHX0802	SNEG1205	WDMT0603	XOMX0903

ASMT1705	LOGU0303	RDHX0803	SNEG1506	WDMT0804	XOMX10T3
AVMT0402	LOHT0603	RDHX1003	SNEU1206	WDMT1205	XOMX1204
AXMT0602	LOMU0404	RDHX10T3	SNGX1104	WDMW0503	XOMX1806
AXMT0903	LOMU1004	RDHX1204	SNGX1306	WDMW06T3	XPET0602
AXMT1235	LOMU1505	RDHX12T3	SNHJ1206	WDMW07T3	XPET1003
AXMT1705	LPGT0102	RDHX1604	SNHU09T3	WDMW0805	XPHT1604
BCMT0903	LPMW0402	RDHX2006	SNHU1204	WDNW09T3	XPHT2206
BDMT0703	LQMU1107	RDKT0802	SNHX1204	WDNW1204	XPKT0602
BDMT11T3	LSMT0202	RDKT10T3	SNKX09T3(45°)	WNGU0403	XPKX12T3
BDMT1704	M270BF10	RDKT1204	SNKX09T3(90°)	WNGU0905	XPLT0603
BDS10N0,8	M270BF12	RDKW0702	SNMT1205	WNGX0403	XPLT0703
BDS12N1,0	M270BF16	RDKW0803	SNMU1206	WNGX0806	XPLX0603



Temos diversos diâmetros e comprimentos mediante consulta

TABELA DE INSERTO

BDS16N1,3	M270BF20	RDKW1003	SNMU1305	WNHU04T3	XPMT06X3
BDS20N1,0	M270BF25	RDKW10T3	SNMU1706	WNHU0604	XPPT0603
BLMP0402	OAKU0605	RDKW1204	SNMX1204	WNHU0806	XPPW0703
BLMP0603	ODHT0605	RDKW12T3	SNMX1205	WNHX0403	ZCMT1003
BLMP0904	ODMT0404	RDMT0803	SNMX1206	WNMG0804	ZDCW0703
BLMP1205	ODMT0504	RDMT1204	SNPJ10T3	WNMU0403	ZDCW09T3
BLMP1306	ODMT0605	RDMT1605	SNPX1406	WNMU0504	ZDEW1204
BNGX10T3	ODMT0606	RDMW07T2	SOEW0803	WNMU0604	ZDMT1205
CCMT0602	ODPW0605	RDMW0803	SOGT1204	WNMU0705	ZDMT1304
CCMT09T3	OEHT0604	RDMW1003	SOMT0602	WNMU0806	ZNCA1203
CCMT1204	OEMT0604	RDMW1004	SOMT0803	WNMU0907	ZNGU1105

Temos ainda outras opções, consulte nosso estoque com um de nossos vendedores



Temos diversos diâmetros e comprimentos mediante consulta



NH TOOLS

Ferramentas Intercambiáveis

FONE: (19) 3784-0052 e (19) 3784-0299

Endereço: R. Atilio Canova, 196 Centro Empresarial de
Indaiatuba- Indaiatuba/ SP

CEP: 13347-439

www.nhtoolsferramentas.com.br

www.nhtoolsferramentas.com.br